



WATER REPELLENT 12 TILE GROUT TECHNICAL DATA SHEET

PURPOSE

PRO GRIP WATER REPELLENT 12 TILE GROUT® is a specially formulated grouting compound with exceptional water repellent properties, making it ideal for use in permanently wet as well as underwater conditions, i.e. swimming pools and showers. This product includes **MILDEW BLOCK** which actively protects against the growth of algae and mildew.

RECOMMENDED FOR

All tiling applications. Replace mixing water with **Pro Grip Bonding Liquid** for high stress applications or for additional waterproofing.

BENEFITS & FEATURES

- a) Permanently wet areas
- b) Actively protects against mildew, algae and bacteria
- c) Smoother texture for easier application



ASK ABOUT OUR
PROGRIP





WATER REPELLENT 12 TILE GROUT TECHNICAL DATA SHEET

**PRO
GRIP**[®]
IT NEVER LETS GO

MIXING INSTRUCTIONS

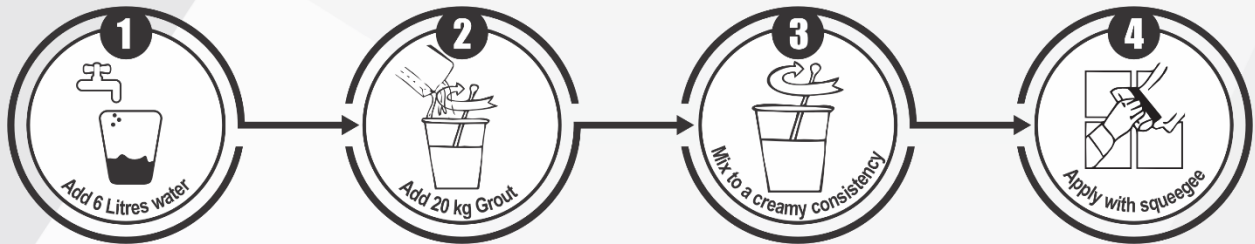

- a. Wear appropriate safety gear before mixing (see MSDS for details).
- b. Add cold water into bucket then slowly add powder. The ratios are as follows:
 - i. **1.5 Lt of water per 5 Kg bag of grout**
 - ii. **6 Lt of water per 20 Kg bag of grout**
- c. For high stress application areas where additional mechanical or water resistance is required, replace the mixing water with **PROGRIP BONDING LIQUID** in the same mixing ratios.
- d. Mix to a creamy consistency. The use of an electric drill and paddle is recommended to ensure thorough mixing.
- e. Let the mixture stand for 2 minutes to ensure the chemical additive are fully dissolved. Remix for 30 sec before using.
- f. Remix if the mixture becomes heavy or stiff. Do not add extra water. Use within 3 hours.

GROUTING RECOMMENDATIONS

Please ensure the installation is performed in strict accordance with SANS 10107:2011, The design and installation of ceramic tiling.

- a. The tile adhesive should be completely set before grouting can take place.
- b. Do not butt joint tiles.
- c. Maintain a minimum joint width of 2mm for wall tiling or 3mm for floor tiling.



*This guideline only serves as a basic manual for the surface preparation, product selection and installation procedure for this type of application. Each installation needs to be assessed on merits and the products used and the procedures followed should be in accordance with the SABS code for the design and installation of ceramic tiles (SABS 10107:2011).



WATER REPELLENT 12 TILE GROUT

TECHNICAL DATA SHEET

**PRO
GRIP**[®]
IT NEVER LETS GO

- d. Ensure that joints to be grouted are sound (no cracks or crumbling), clean, free of dust and contaminants.
- e. Ensure that the joints are free of excess tile adhesive.
- f. Grout joints should be slightly moistened but not wet, prior to application.

PRODUCT APPLICATION

- a. Apply **PROGRIP WATER REPELLENT 12 TILE GROUT** liberally to the surface and work into the joints with a grout squeegee taking care to completely fill the joint.
- b. Remove excess grout and level the surface by moving the grout squeegee diagonally across the joints while the mix is still fresh.
- c. Allow the grout to harden for 1 - 2 hours before removing the excess grout residue from the tiles with a damp (but not wet) sponge. Rinse the sponge frequently to achieve the best results.
- d. Once the grout has completely set (after 24 Hrs), polish the tiles with a dry soft cloth. A wet cloth will not remove the thin film of grout residue.

EXPANSION JOINTS

- a. Perimeter expansion joints should be installed on all tiled surfaces – walls and floors.
- b. Perimeter expansion joints should also be installed around any columns, staircases and any other projecting components.
- c. Movement joints must be installed on external wall joints (close to external angles) and all internal angles.
- d. Movement joints must be incorporated at more frequent positions, should the walls be subject to significant thermal or vibration movement.
- e. These joints should be left empty and covered with skirting boards or if exposed, filled with a flexible sealant like **Pro Grip Expansion Joint Sealant**.



*This guideline only serves as a basic manual for the surface preparation, product selection and installation procedure for this type of application. Each installation needs to be assessed on merits and the products used and the procedures followed should be in accordance with the SABS code for the design and installation of ceramic tiles (SABS 10107:2011).



WATER REPELLENT 12 TILE GROUT TECHNICAL DATA SHEET

**PRO
GRIP**[®]
IT NEVER LETS GO

- f. Intermediate expansion joints should be installed when the tiling span is longer than 5m on surface bed applications or 3m on suspended surfaces. Fill with a suitable sealant like **Pro Grip Expansion Joint Sealant**.

PRECAUTIONS & LIMITATIONS

- Install in moderate ambient conditions i.e. at temperatures between 10°C and 30°C and protect from excessive wind.
- Adhere to good health and safety practises – wear rubber gloves and goggles to protect hands and eyes.
- Keep adhesive away from children and pets. Do not ingest.
- Do not wash excess material into drains. Allow to harden and dispose with solid waste.



COVERAGE TABLE

COVERAGE - SQUARE METERS PER 5 KG BAG						
Tile Size in mm	Tile Thickness	Spacer in mm				
		3	5	6	8	10
200 x 100	7	7,6	4,5			
350 x 350	7	19,8	11,9	9,9	7,4	6,0
430 x 430	8	21,3	12,8	10,7	8,0	6,4
600 x 200	9	13,2	7,9	6,6	5,0	4,0
600 x 300	8	19,8	11,9	9,9	7,4	6,0
600 x 600	8	29,8	17,9	14,9	13,4	8,9
800 x 800	10	31,7	19,0	15,9	11,9	9,5
950 x 240	10	15,2	9,1	7,6	5,7	4,6
1200 x 600	10	31,7	18,3	15,9	11,9	9,5
ADD 10% MORE MATERIAL TO COVER ANY WASTAGE						

*This guideline only serves as a basic manual for the surface preparation, product selection and installation procedure for this type of application. Each installation needs to be assessed on merits and the products used and the procedures followed should be in accordance with the SABS code for the design and installation of ceramic tiles (SABS 10107:2011).