

# Freestanding & Skirted Baths Installation Guide

## Important

Please read these instructions before installing the bath  
We recommend a qualified plumber/electrician for this job.

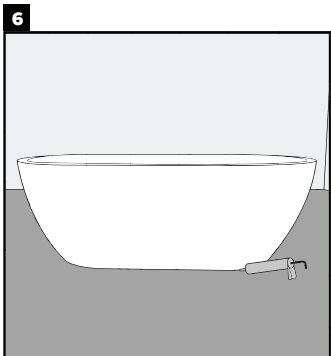
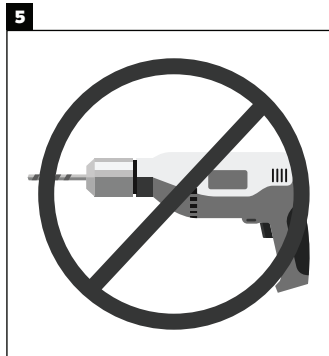
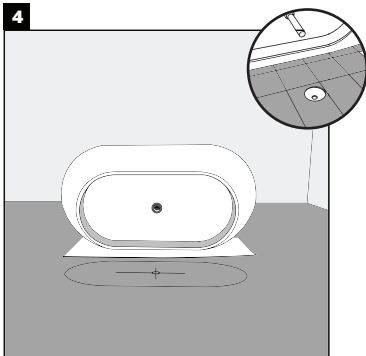
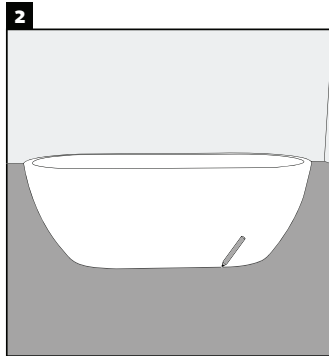
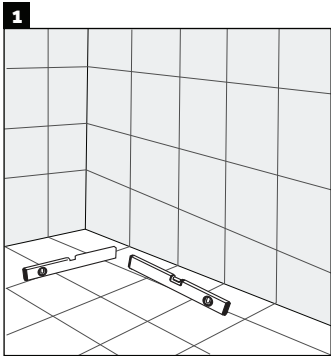

1. Clean the floor and ensure that the bath is level by using the spirit level. Adjust the feet until the required level is achieved. For wall-mounted models, attach the rim to the brackets.
2. Position the bath in the desired final position and trace its contours with a pencil.
3. Turn the bath on its side. Ensure that a rug is used to prevent the bath from getting damaged. Connect the waste pipe to the p-trap using a flexible bath connector to Once connected, the bath can be placed onto the marked position..
4. Do not cut or drill holes into the bath. This will compromise the stability and warranty of the product. Install all the traps and fittings. The Nicci Spout can be used as both an outlet and inlet.
5. Make sure the bath is flush with the floor for stability. Use silicone to seal the contours of the bath. Leave for 24 hours to set.